



HORN LAKE 55 BUSINESS CENTER

BUILDING B

580 Nail Rd West, Horn Lake, MS 38637

200,268 SF Available - MOVE IN READY



COMMERCIAL
ADVISORS

LEASING AGENT



CORE5
INDUSTRIAL PARTNERS

DEVELOPER

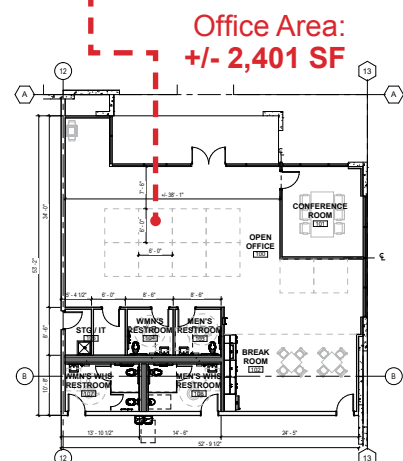

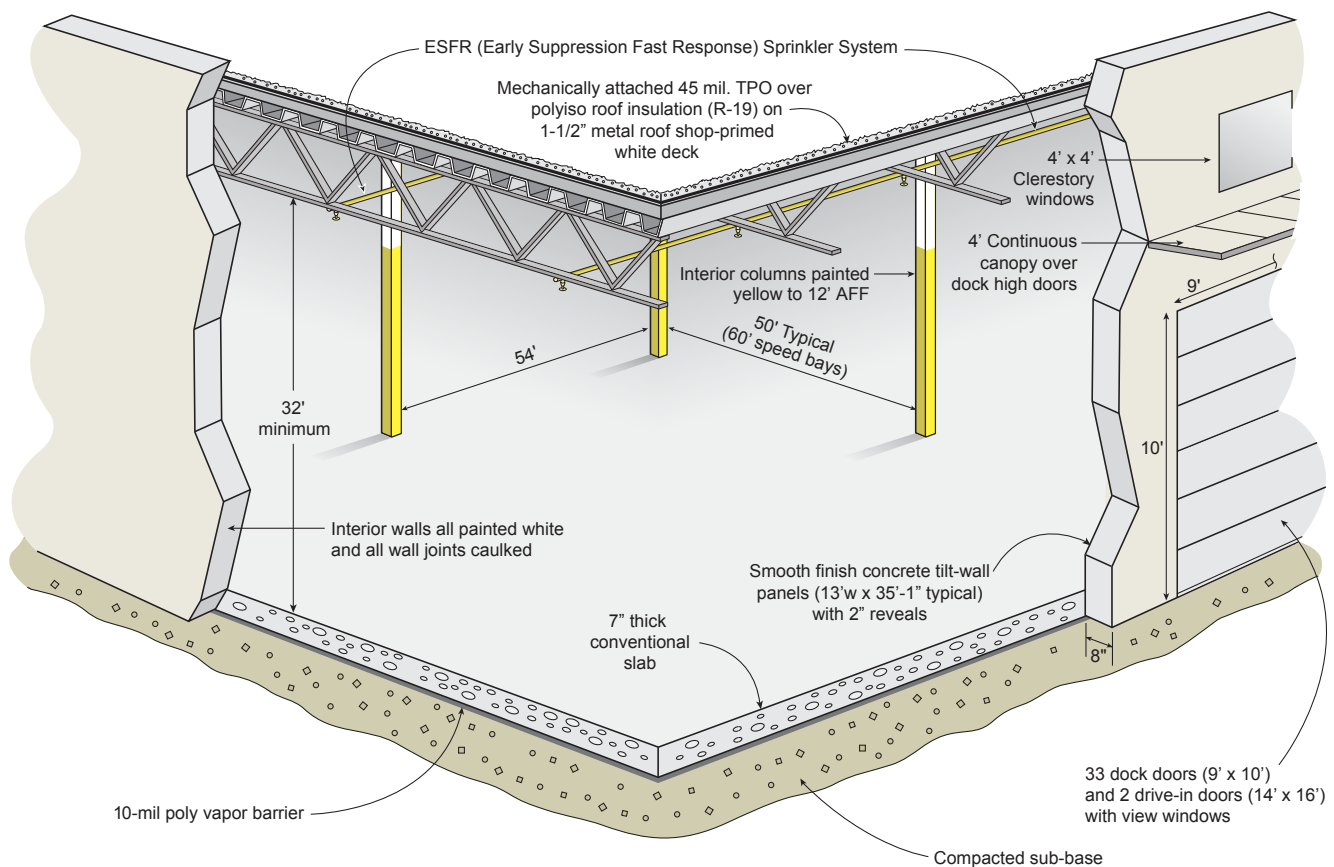

BUILDING SPECIFICATIONS

Square Footage	±200,268 SF (648' x 310')
Site Area	+/- 24.18 acres
Office Area	2,401 SF of office space
Configuration	Rear Load
Slab Thickness	7" thick, 4,000 psi conventional slab
Column Spacing	54' wide x 50' deep typical, with 60' loading bay
Clear Height	32' clear minimum
Dock High Doors	33 – 9' x 10' insulated dock high doors with 4' exterior continuous canopy
Drive-In Doors	2 – 14' x 16' ramped, drive-in doors
Truck Court Depth	185' truck court inclusive of a 60' deep concrete apron
Auto Parking	180 auto spaces
Trailer Storage	47 trailer spaces
Warehouse Improvements	LED lighting on motion sensors at 25 FC based on open plan 40,000-lb Rite Hite mechanical pit levelers on 16 dock doors (every other door) Two 1,000 amp transformers and switch gear, for a total of 2,000 amps Ten forklift chargers
Sprinkler	ESFR sprinkler system with fire pump

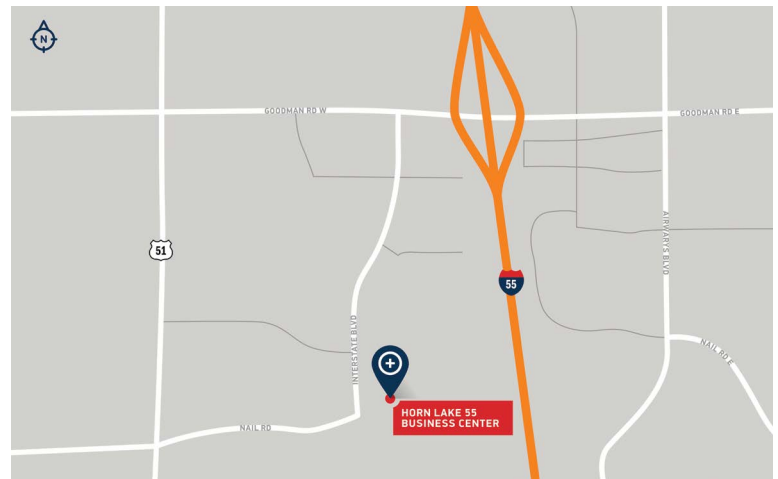
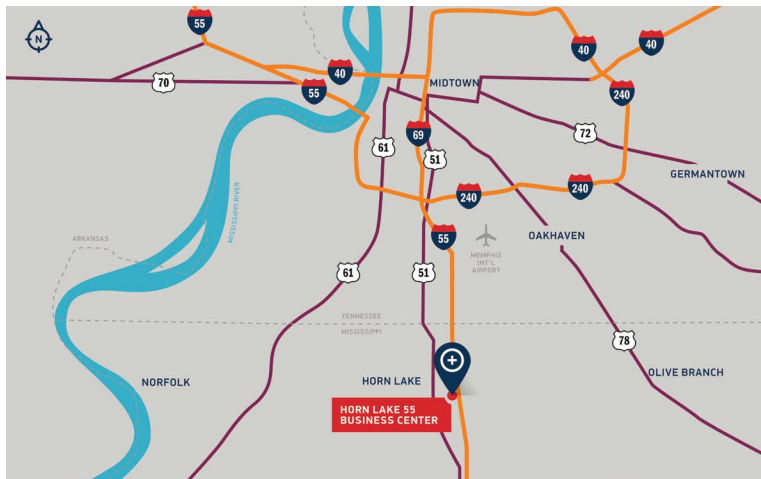

**DAYS TRUCK
DRIVE TO/FROM
MISSISSIPPI**

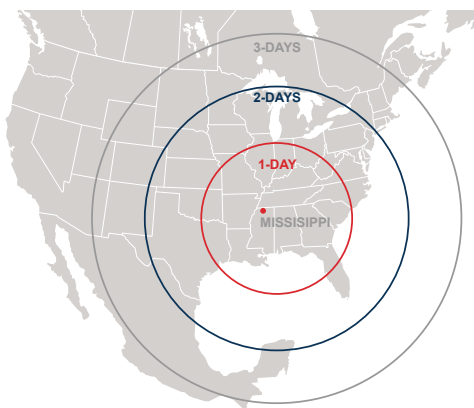

Rodney Davidson
Vice President Investments

O 404.262.5432
C 678.524.8812

rdavidson@c5ip.com



Kemp Conrad
Vice Chairman & Principal

O 901.366.6070
C 901.292.4653

kconrad@commadv.com

© Copyright 2021 Core5 Industrial Partners, LLC. All rights reserved.
CORE5, CORE5 INDUSTRIAL PARTNERS, and the stylized "C" CORE5 INDUSTRIAL PARTNERS design / logo are service marks of Core5 Industrial Partners, LLC for its real estate services, namely, acquisition, rental, brokerage, development, leasing, and management of industrial real estate property. These marks may not be used without express permission of Core5 Industrial Partners, LLC.